

AUTHOR AIRMAN brake operating instruction

Welcome you to use AUTHOR AIRMAN frame set brake system. About the brake assembly, please follow up with below operation.

Please prepare below tools, so that we can follow below process to operate.

Tooling name:

Allen wrench:2.0mm/3.0mm/4.0mm;

Torque wrench

Pinchers

Grease

Once the tooling is ready, so that we can start to assemble the brake!!

1st step: please check the brake parts no./Q'TY.

When you open the carton, you will find 2 brake packages, each bag should be included below parts.

PS: In future, each frame cartons will be put into 2 brake bags. One is for frame, one is for fork. Please make sure you get 2 brake bags and check each one parts below :

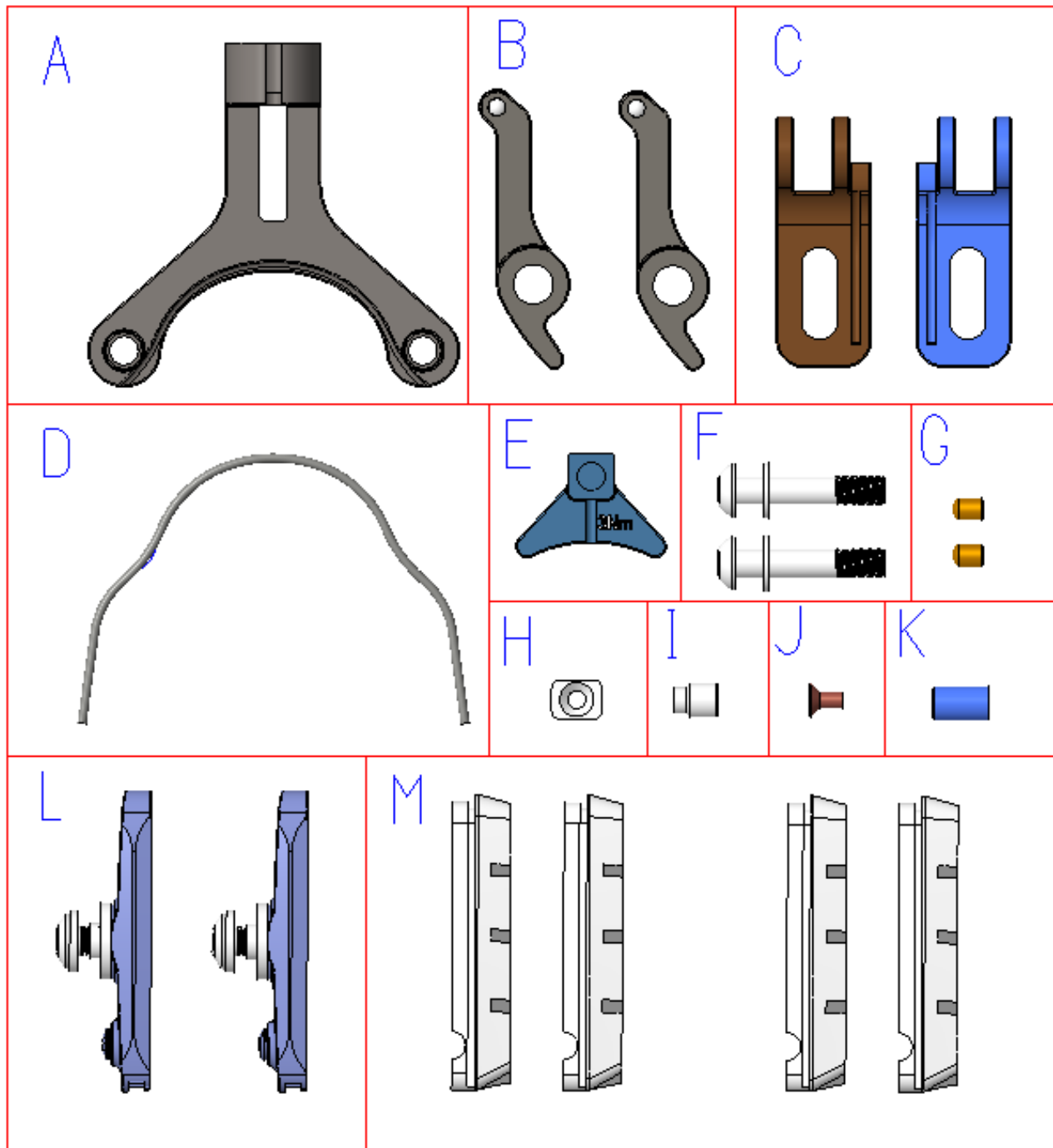

Number	Part Name	Q'TY
A	Brake body	1PC
B	Brake arm(W/sheave)	2PCS(L/R)
C	Brake arm	2PCS(L/R)
D	Brake spring	1PC
E	Triangle block	1PC
F	M5 screw and washer	2PCS
G	Adjusted screw(M4)	2PCS
H	Slipping block	1PC
I	Screw(M6)	1PC
J	Screw(M3)	1PC
K	Brake cable cap	1PC
L	(Brake shoe)Bodysets+Screw+washer	2PCS(L/R)
M	Brake shoe(Carbon rim+ Alloy rim use)	2SETS(4PCS)

2nd step: Applying the grease on Part A/B/C/E.

To avoid smoothly when braking, please make sure below red area to apply the grease enough.

Part A:

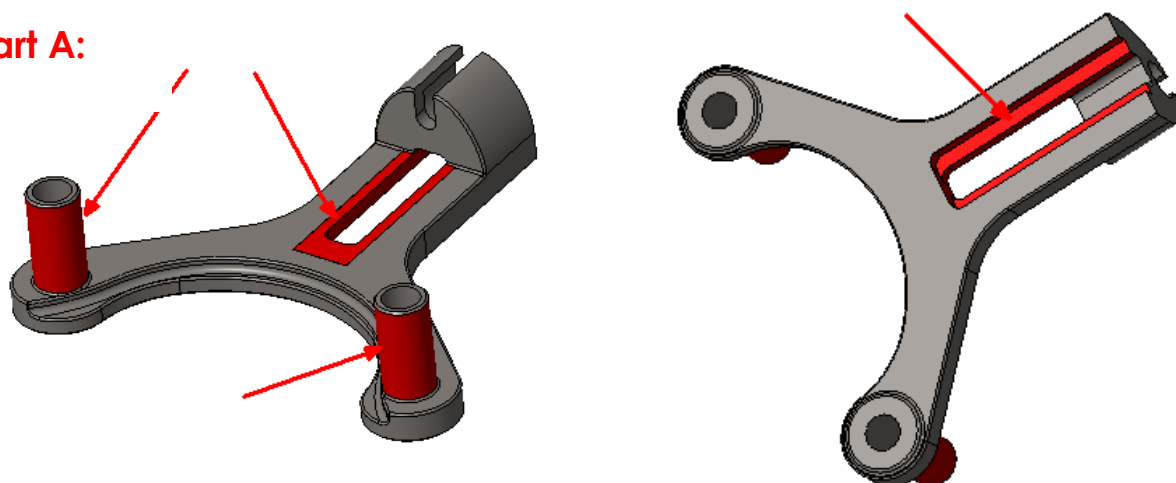

Part B:

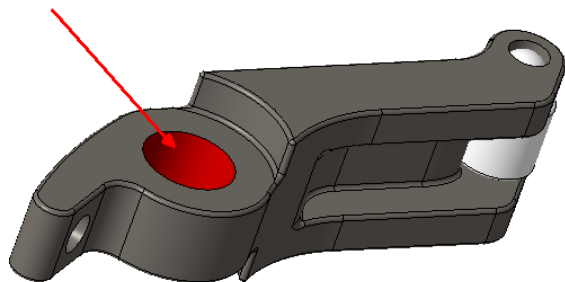

Part C:

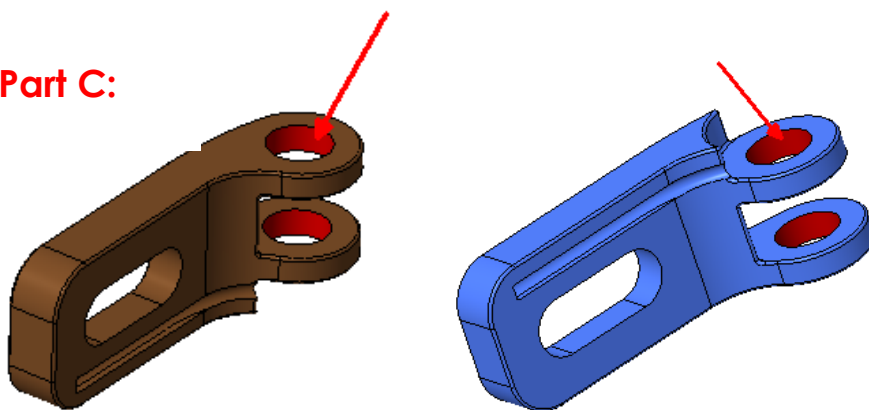

Part E:

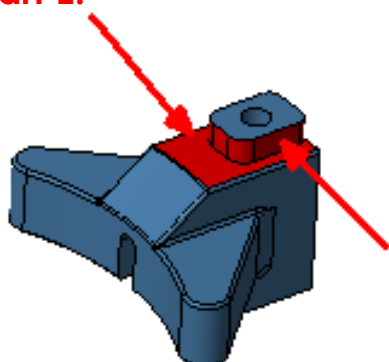

3rd step: Using the Allen wrench to assemble Part E/H/J on Part A.

Please follow below picture to operate, the torque value is 5kgf.cm, when locking the screw, to make sure the Part E can move forward and back.

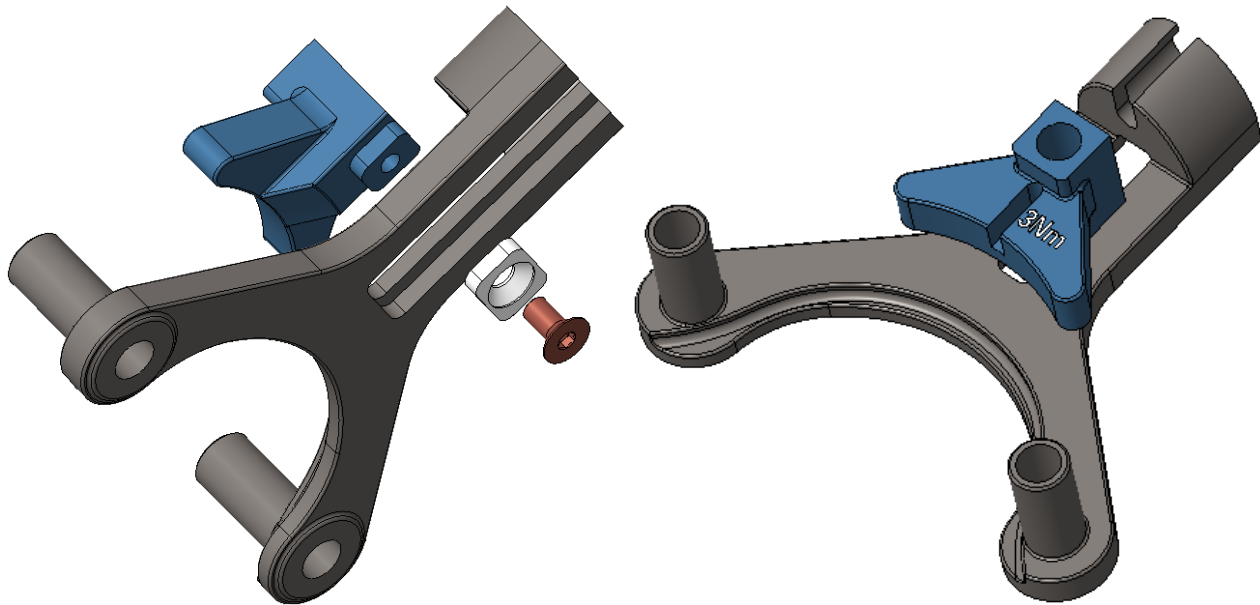

4th step: Put the brake cable into the brake cable cap.

To use the Pinchers to cut the brake cable, when the cable appeared the frame or fork around 20mm length, then put the cable into the brake cable cap, as below drawing show distance.

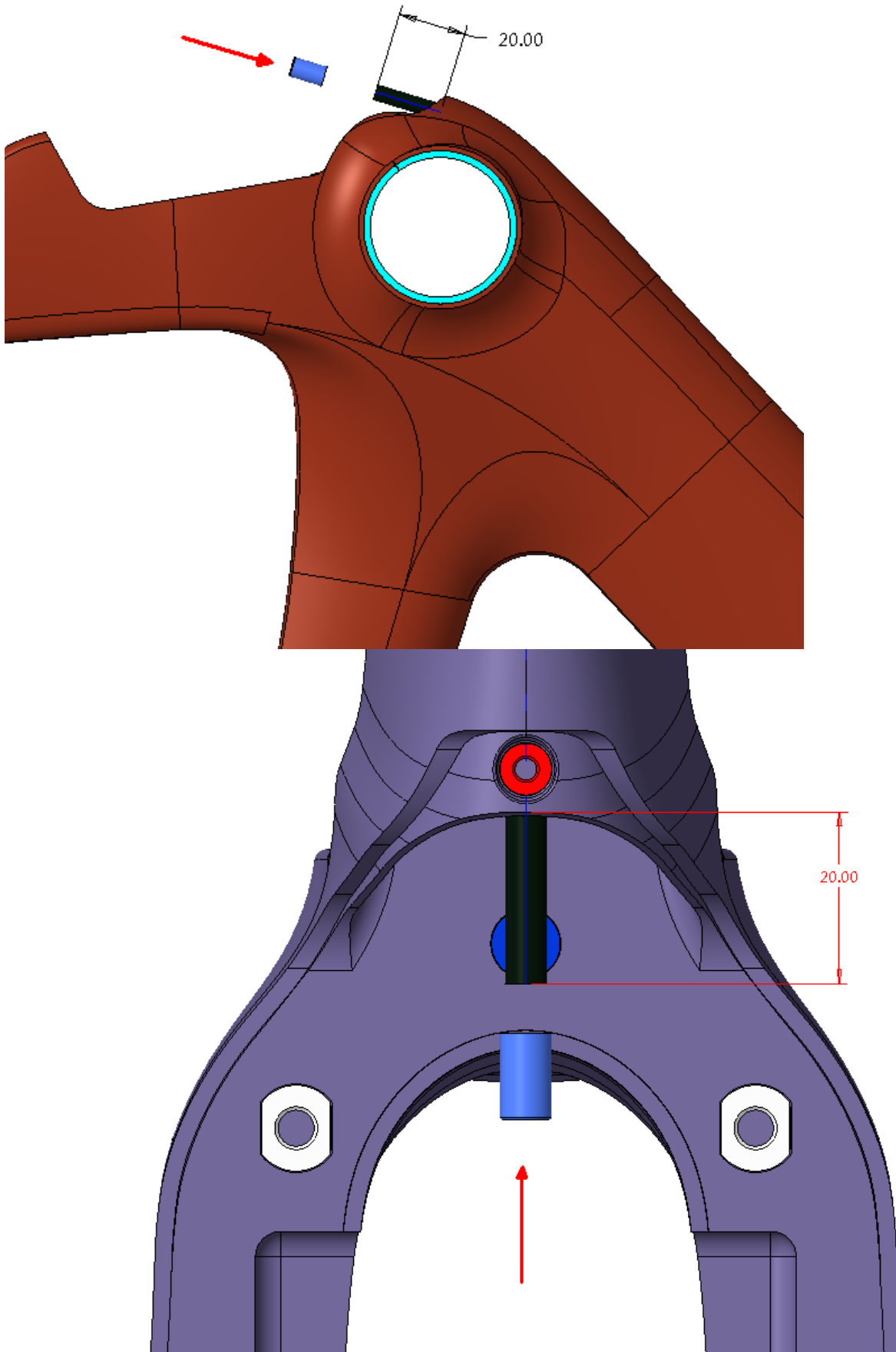

5th step: Keep 29mm brake cable outer then cutting.

When the brake cable routed from the H/B brake lever, please pull tense the cable, the cable exceed 29mm to cut, allowance the tolerance is $\pm 1\text{mm}$.

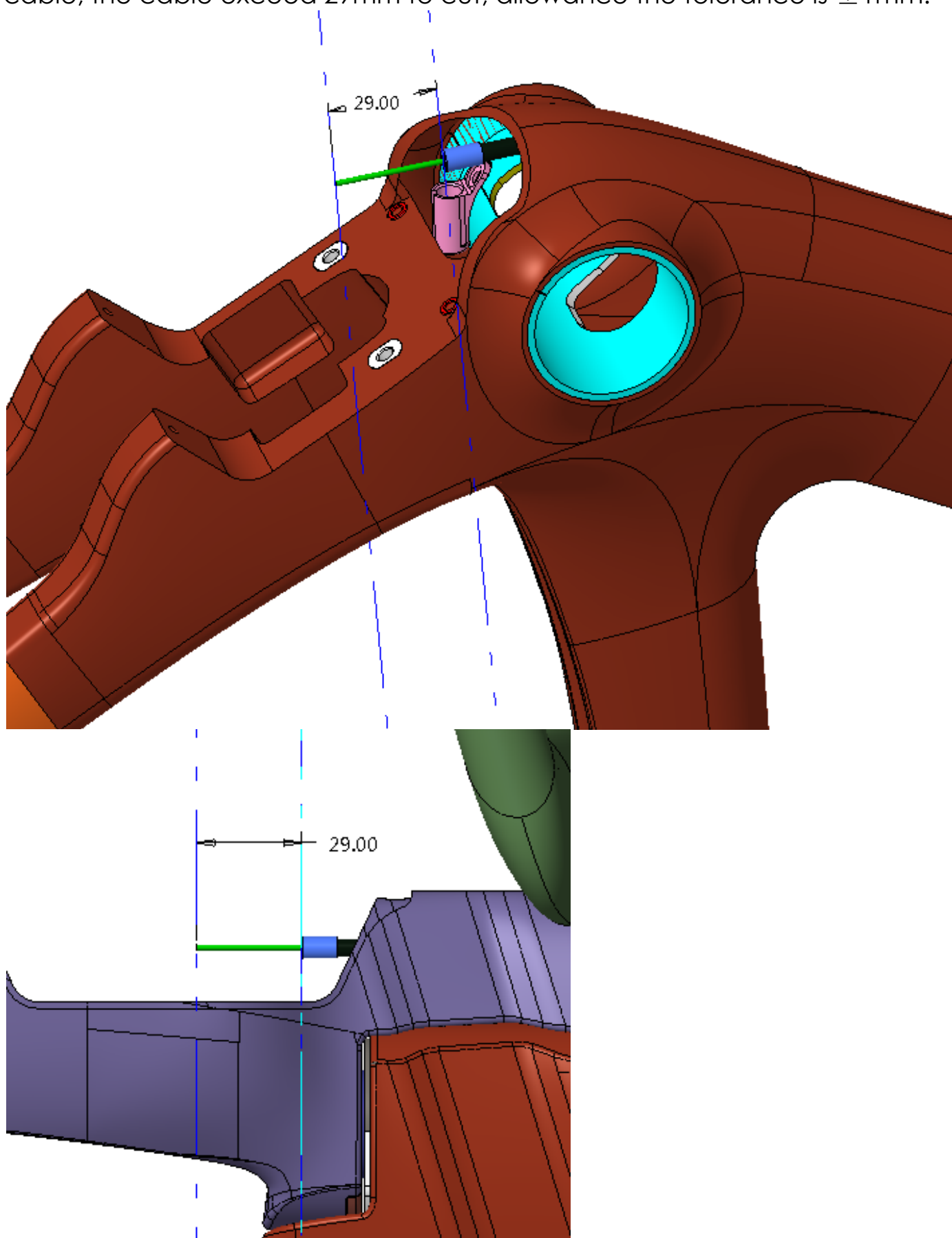

6th step: To route the cable into the brake.

Please follow up with below picture to put the cable into the triangle block, to make sure the cable is parallel with the triangle block end. Then using 3.0mm wrench to lock, using the torque wrench, to make sure the torque value is 3Nm.

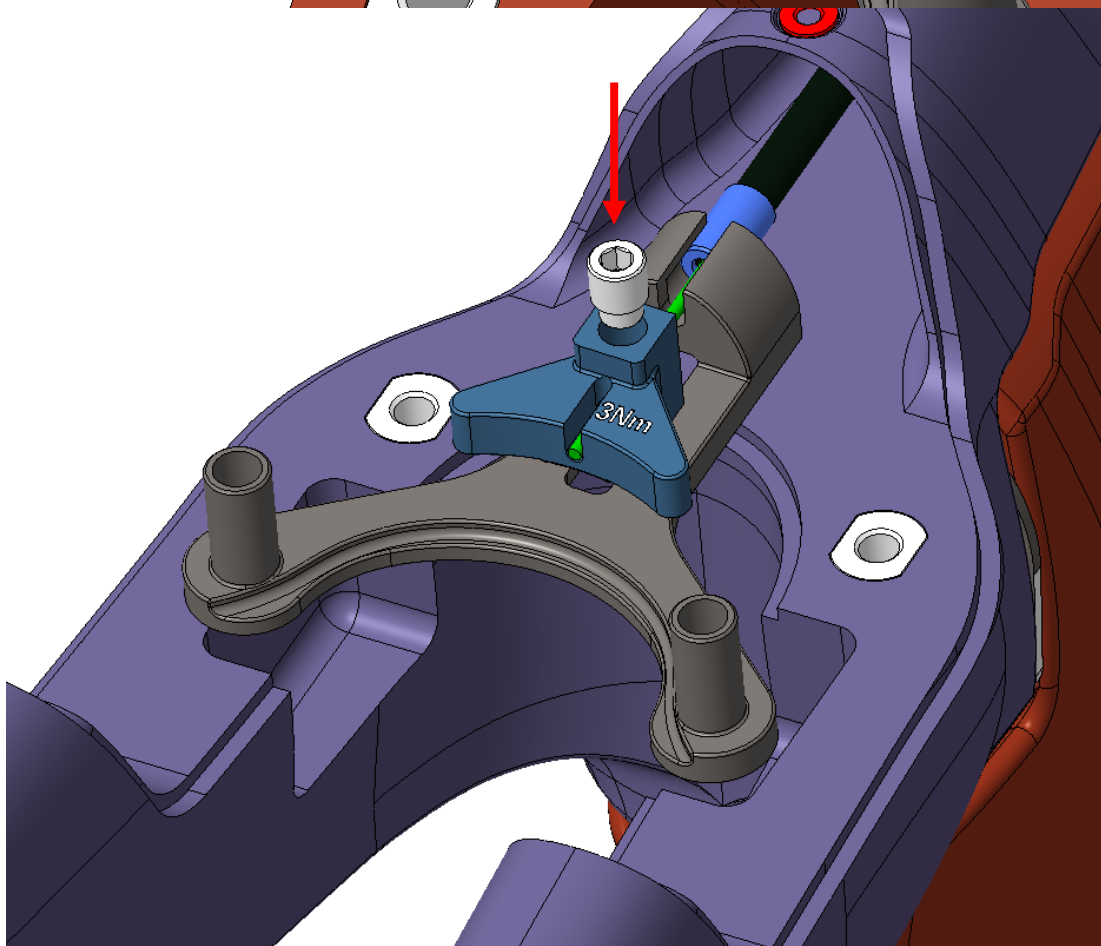
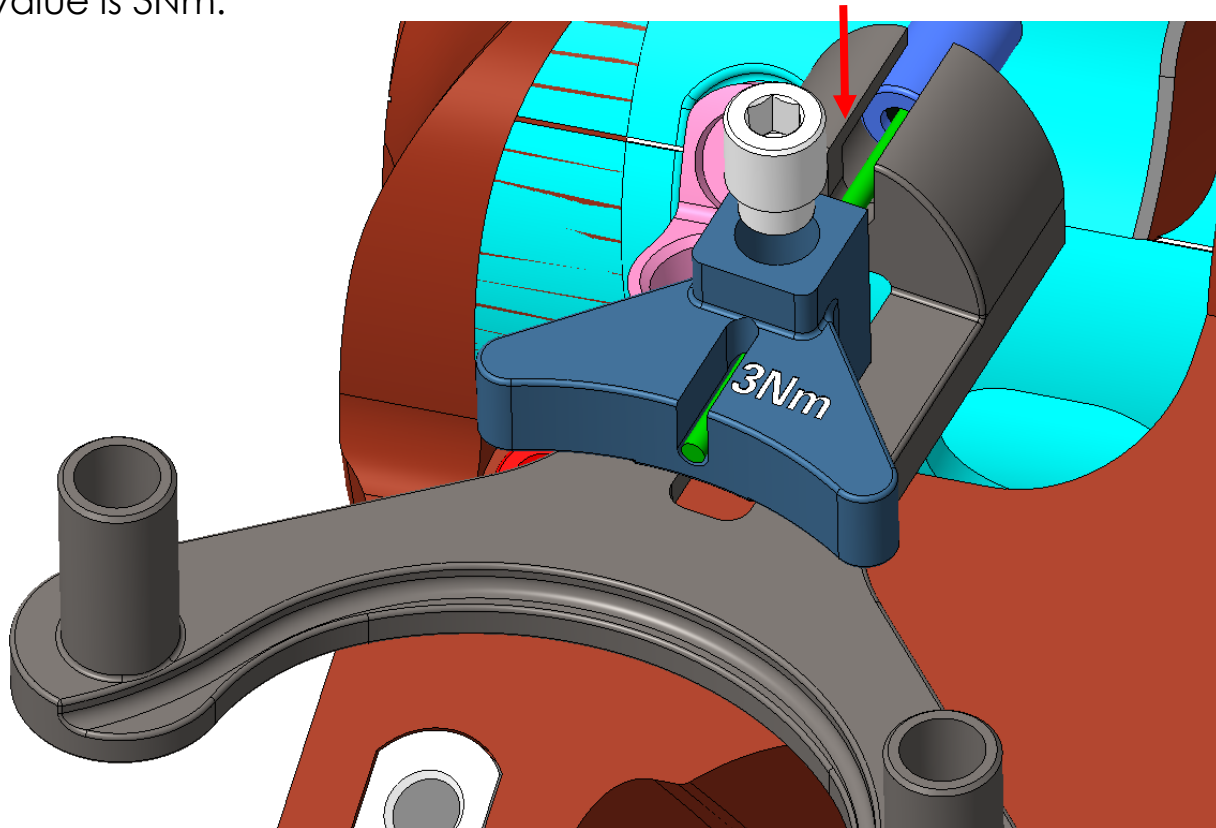

7th step: Assemble the brake arm like below way:

Please followed below picture to assemble with Part B and Part C together, please make sure to distinguish with left and right.

As the frame and the fork used the same brake, so please make sure to assemble 2 sets.



8th step: Put the assembled arm to the brake body.

To assemble the arm into the brake body, to make sure the arm can be revolve smoothly.

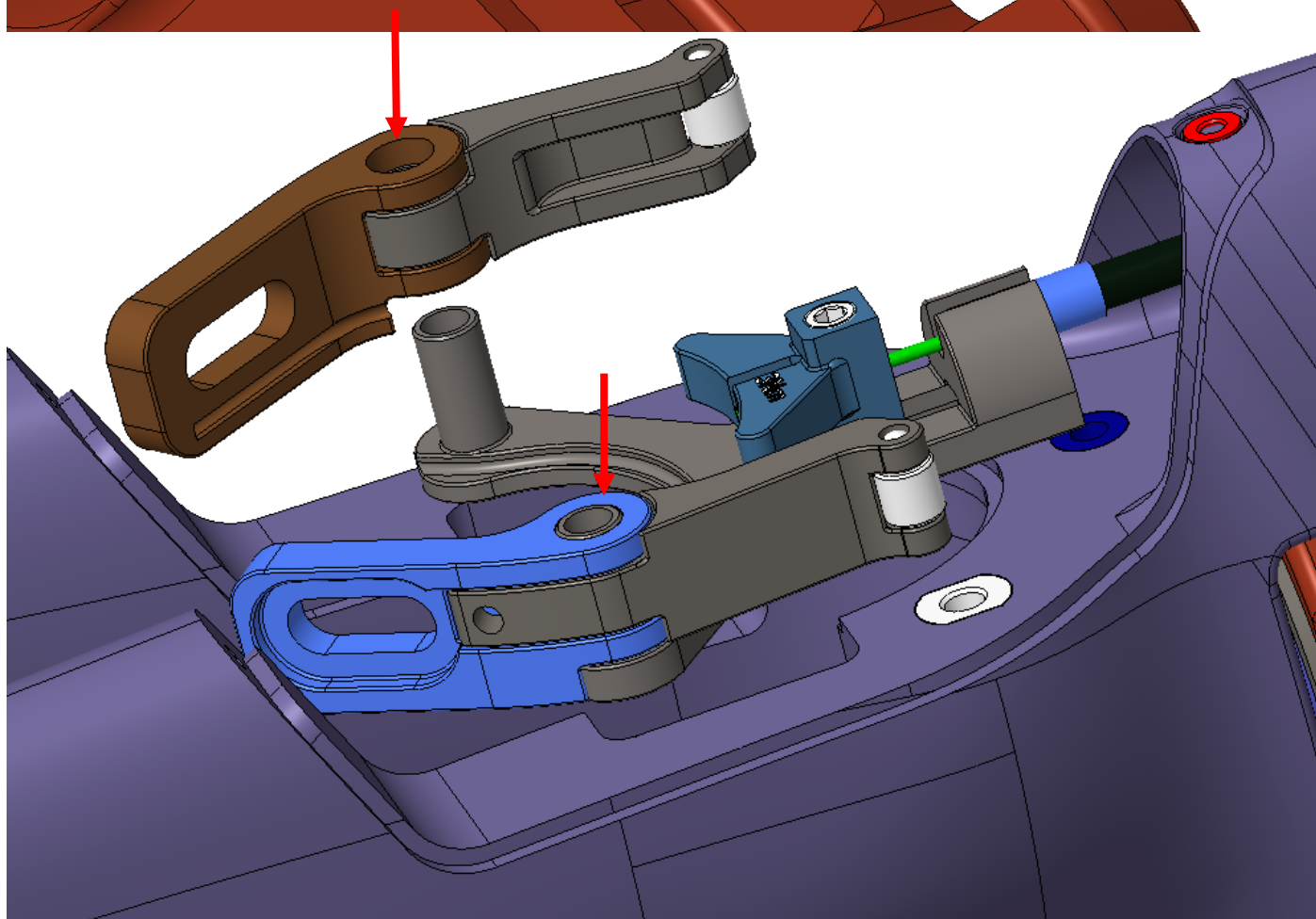
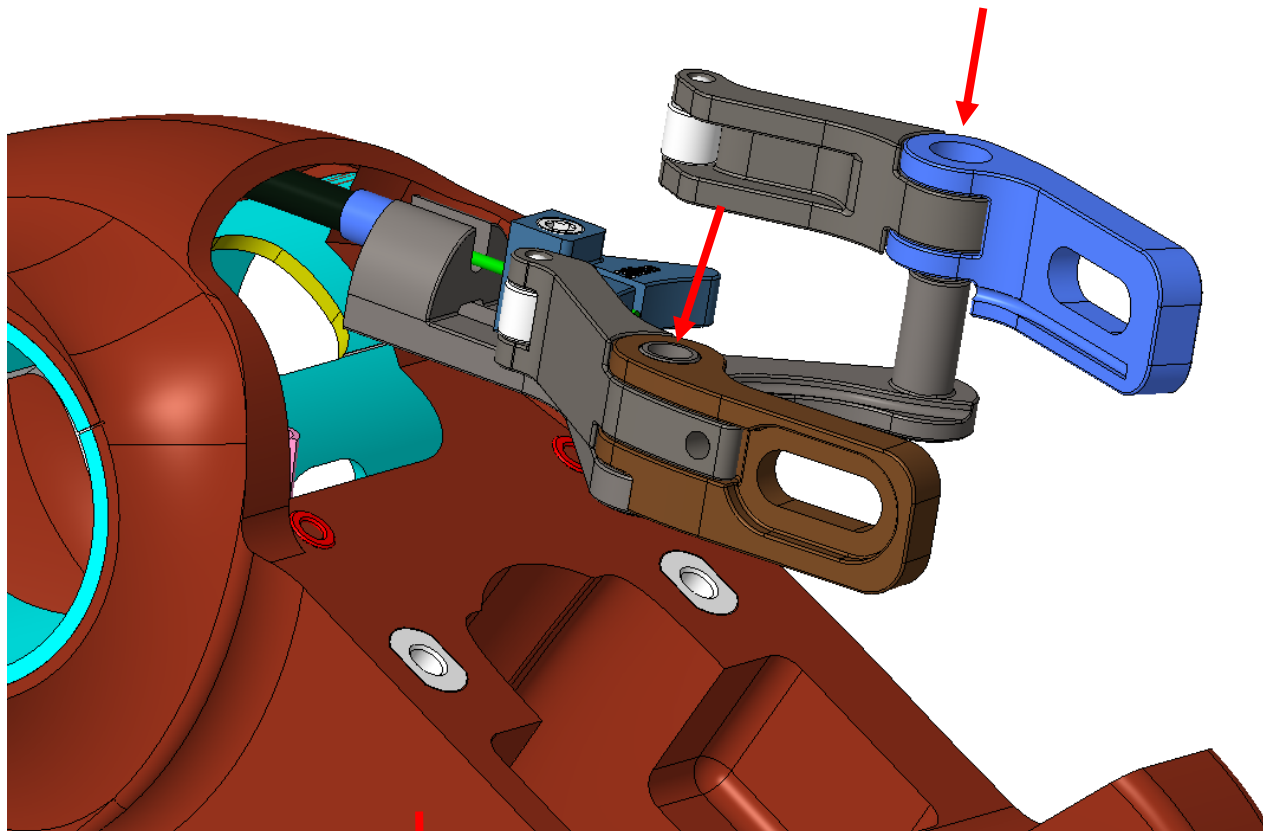

9th step: Locking left and right side M5 screw.

To make sure the brake body hole in line with the frame and fork, then mounting M5 screw locked, using 3.0mm wrench to lock, the torque value is 5Nm.

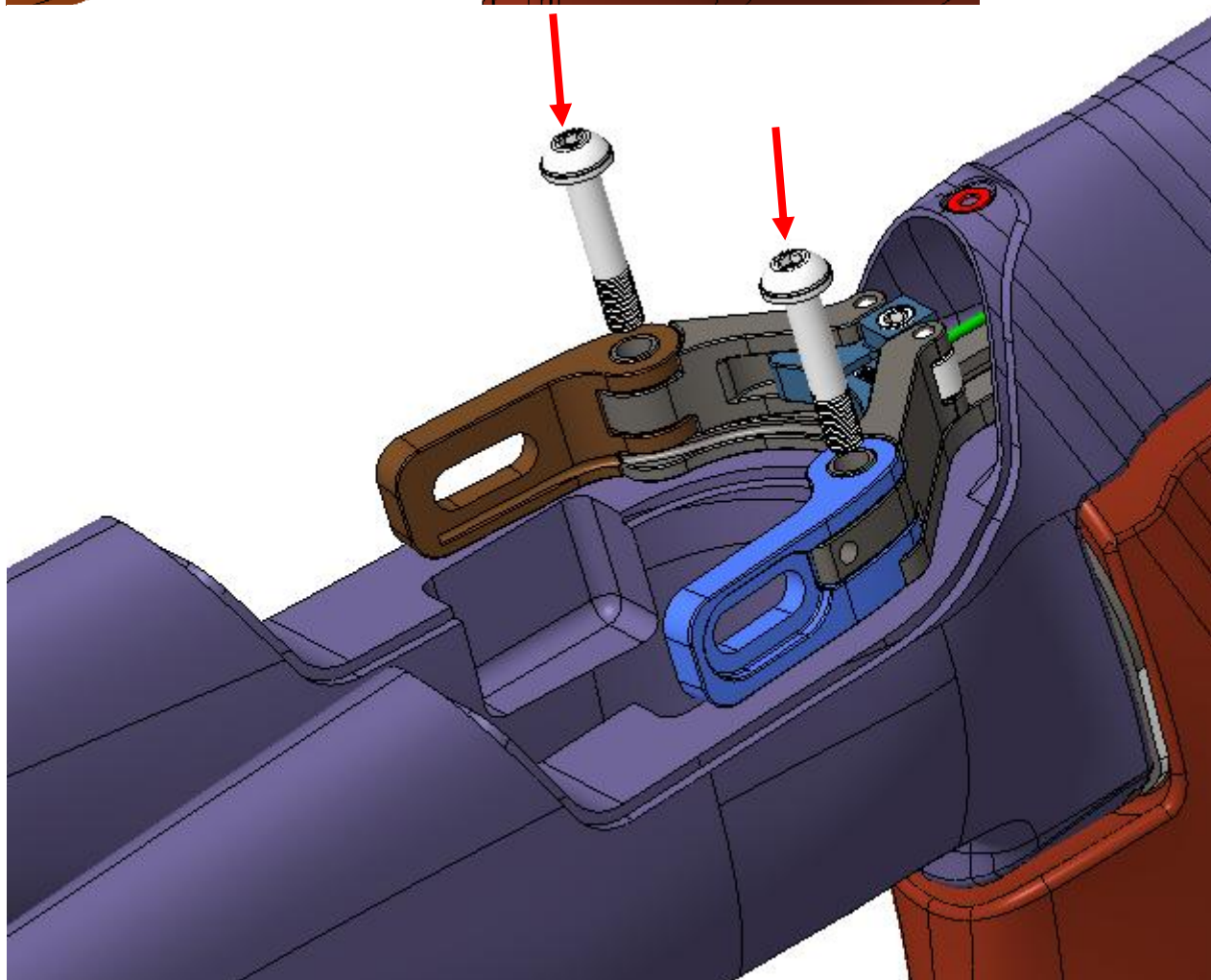
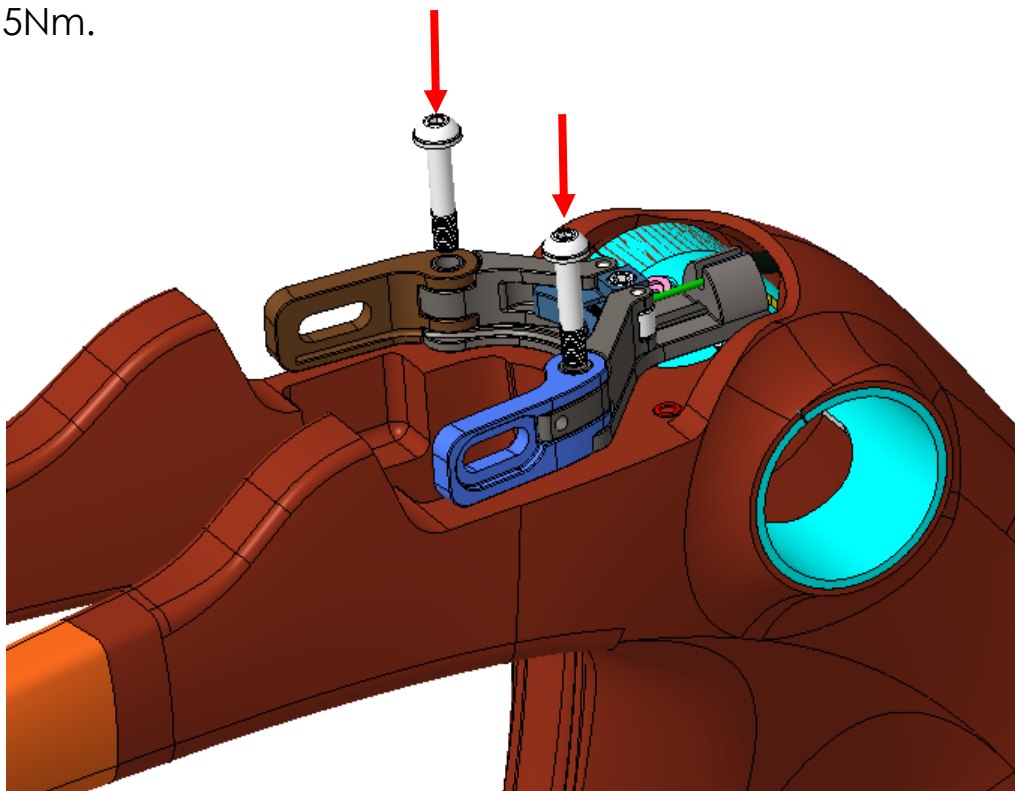

10th step: To assemble the spring into the brake, following below:

Please be sure the spring will be put into the spring groove, make sure spring (right/ left) completed inside groove like below.

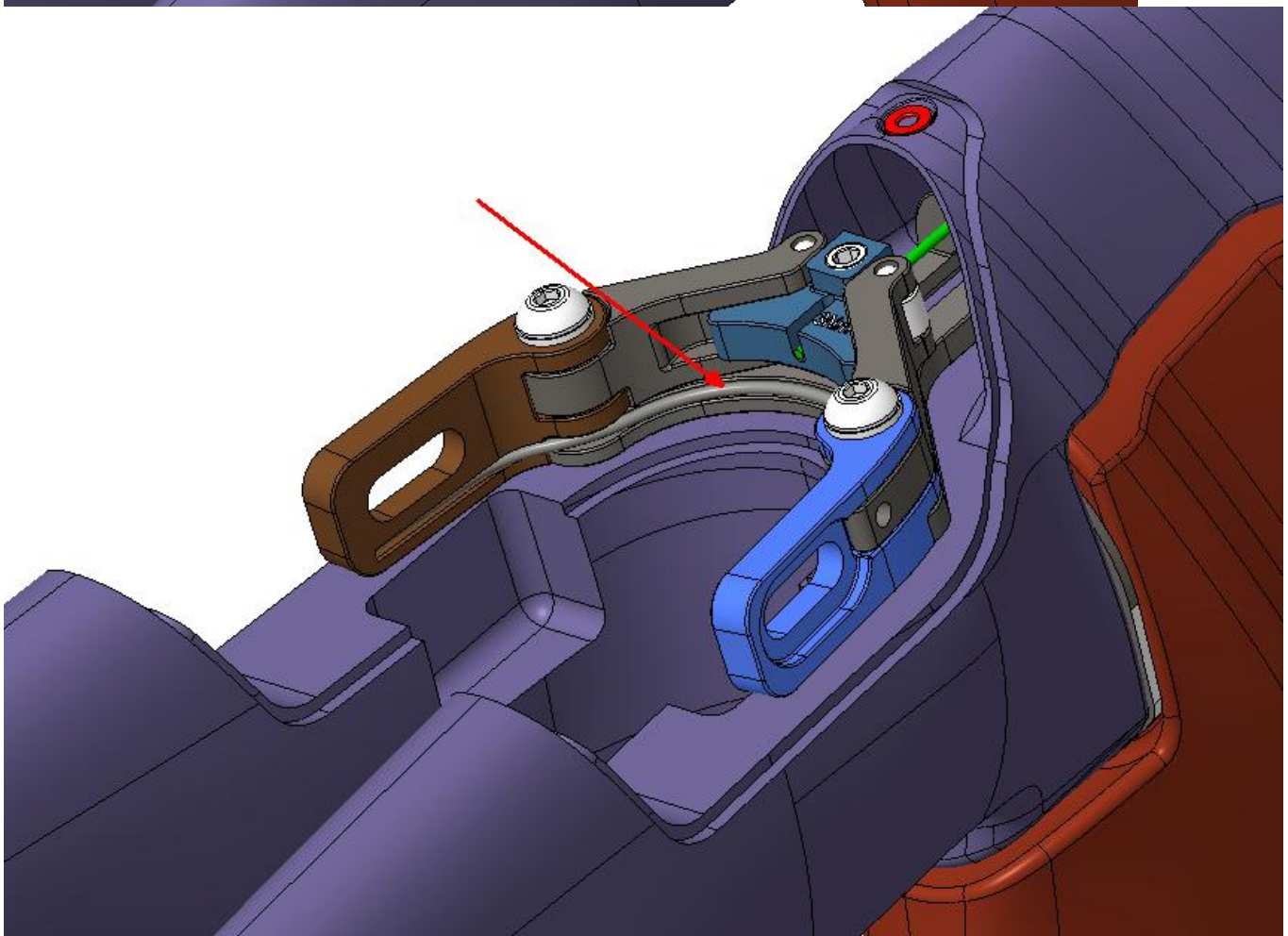
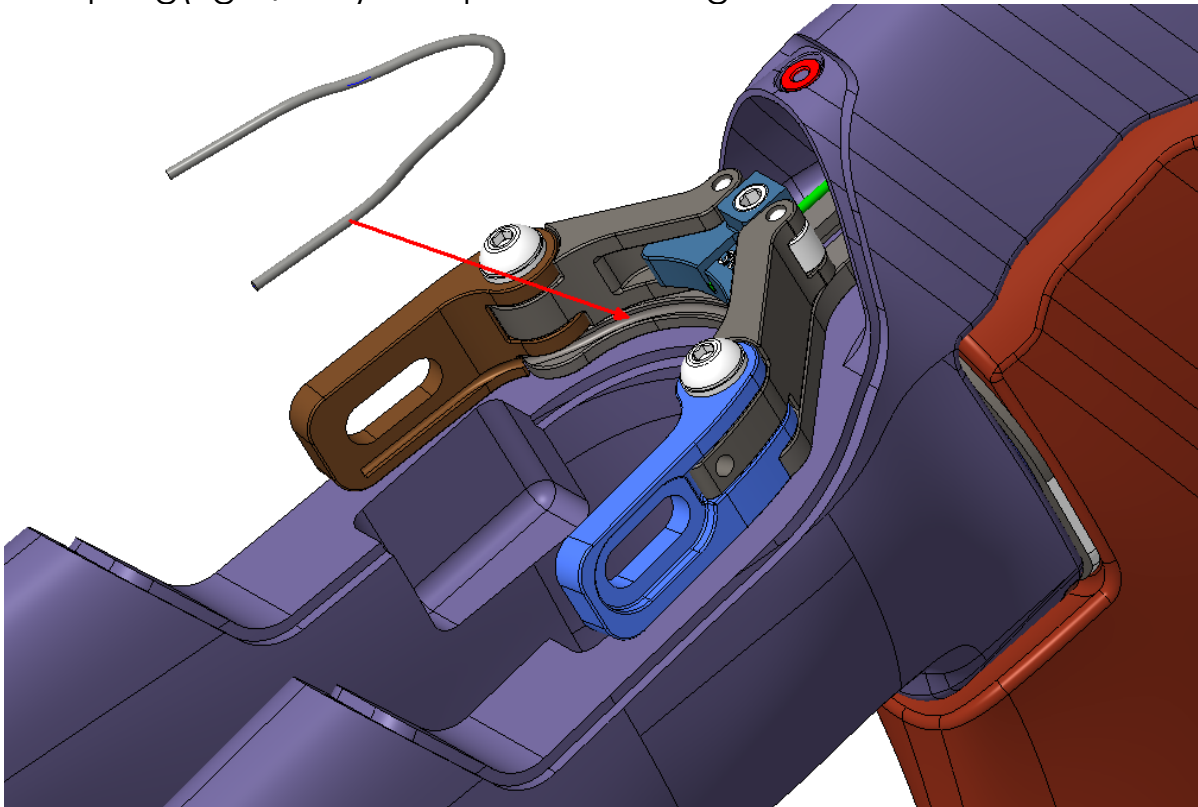

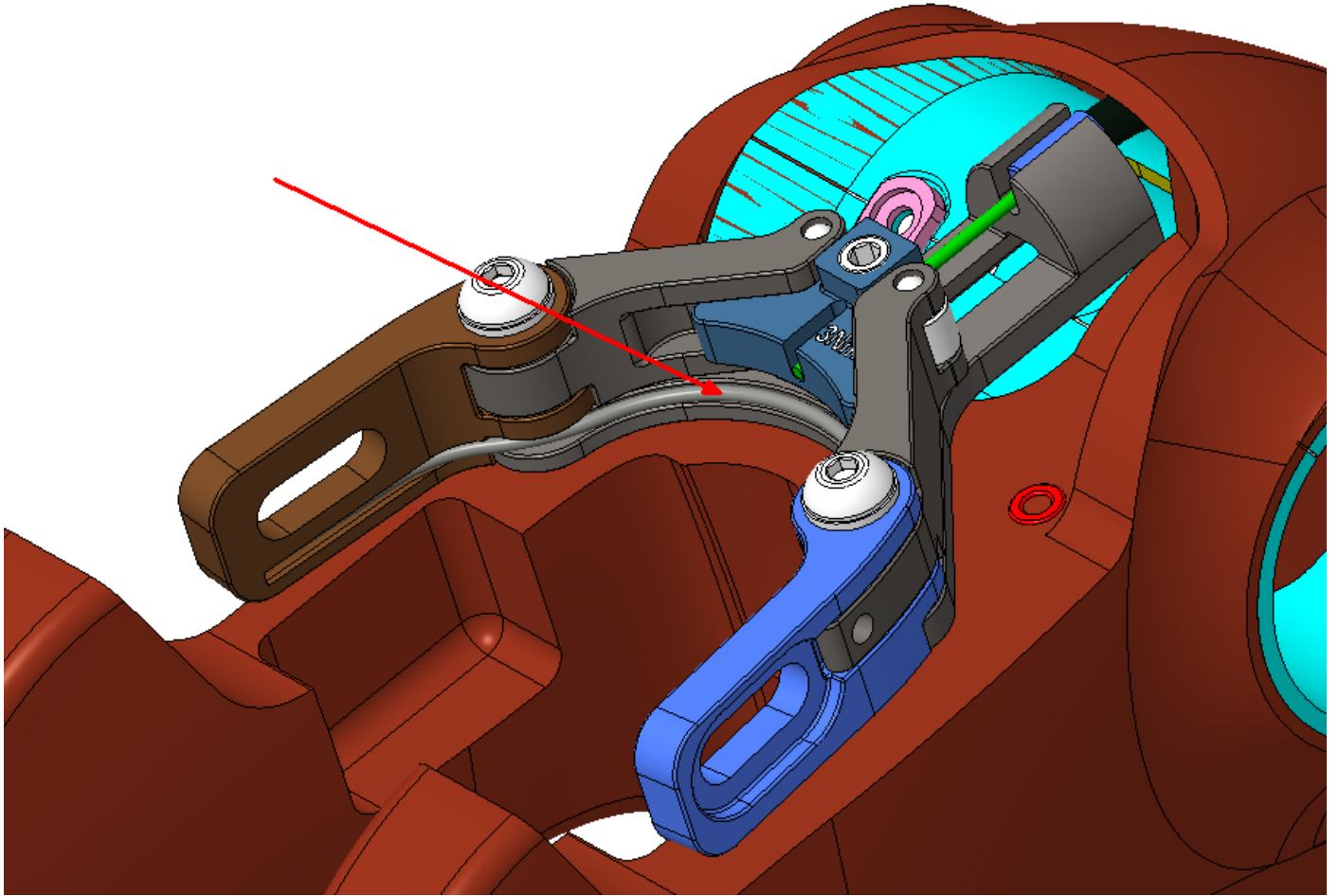

11th step: Assembled Part G with the brake and make sure the brake arm is parallel.

Please follow below to assemble the adjusted screw on each side brake arm, meanwhile, please adjust both side the brake arm with parallel.

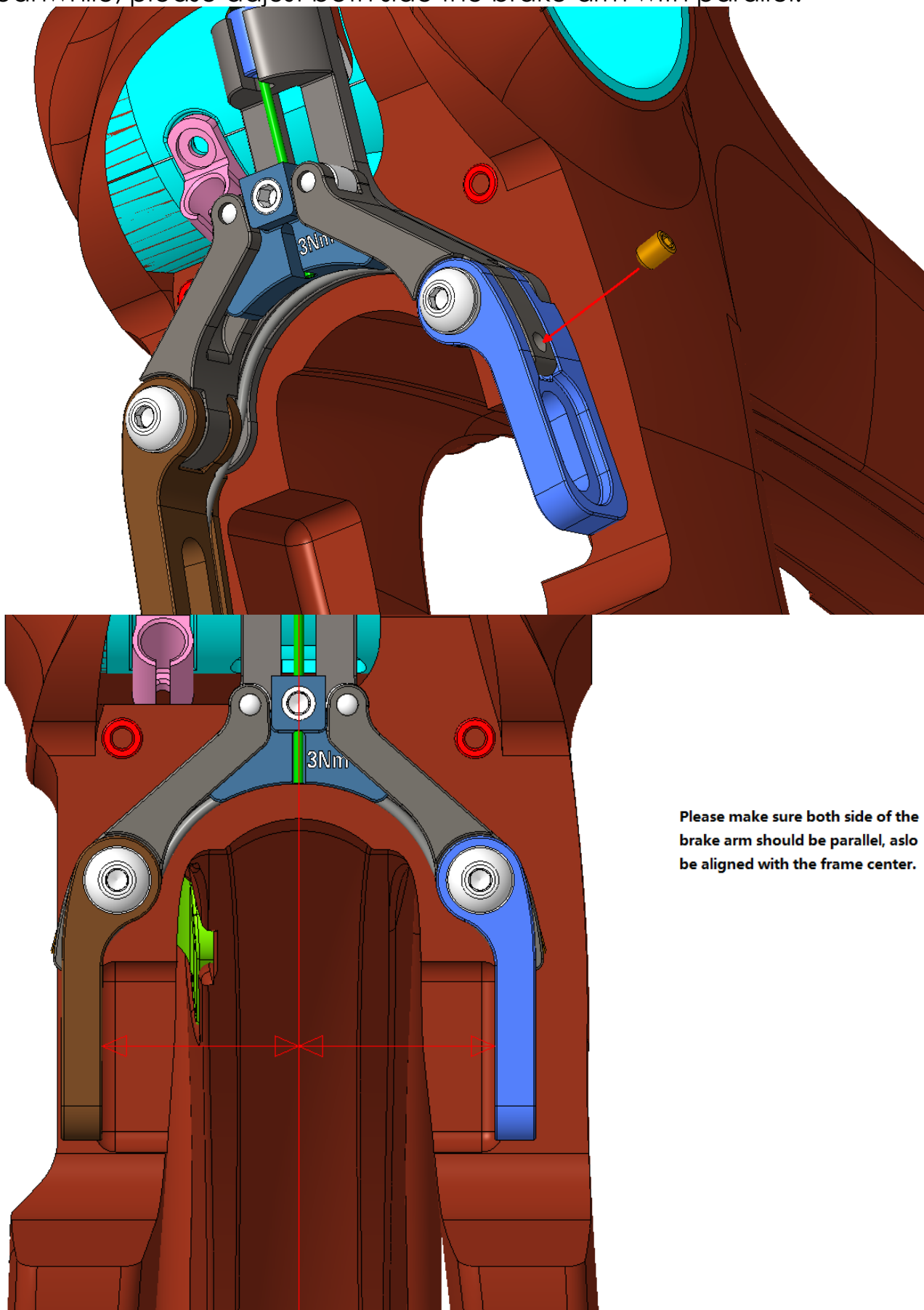

Please make sure both side of the brake arm should be parallel, also be aligned with the frame center.

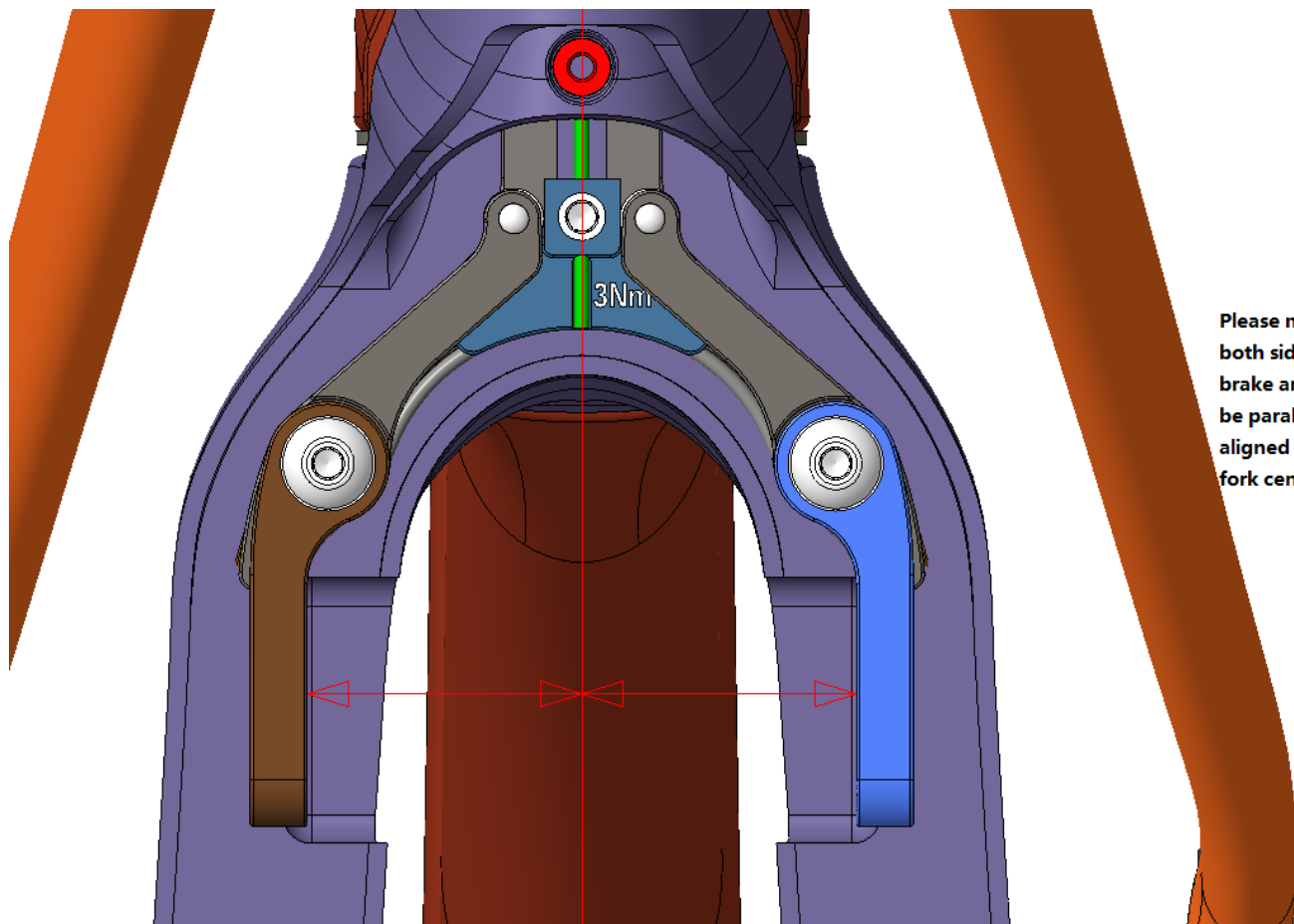

Please make sure both side of the brake arm should be parallel, also be aligned with the fork center.

12th step: According to your rim material to choose the correct brake shoes, then assemble.

According to consumer's request to assemble the correct brake shoes, because different rim material using different shoes.

To put the correct brake shoes to assemble in position, using 4.0mm wrench to lock, the torque value is 6Nm.

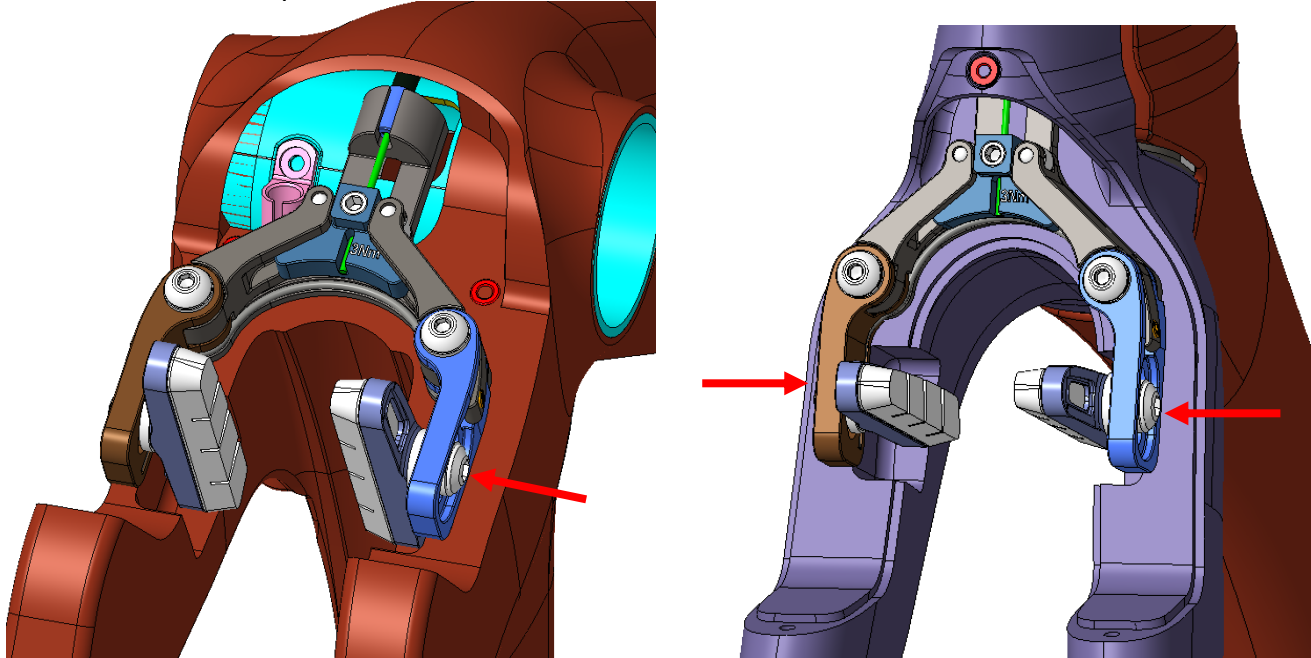

Key point: When the brake assembled in normal status, the shoes clearance should be 27mm, please to use the suitable rim.

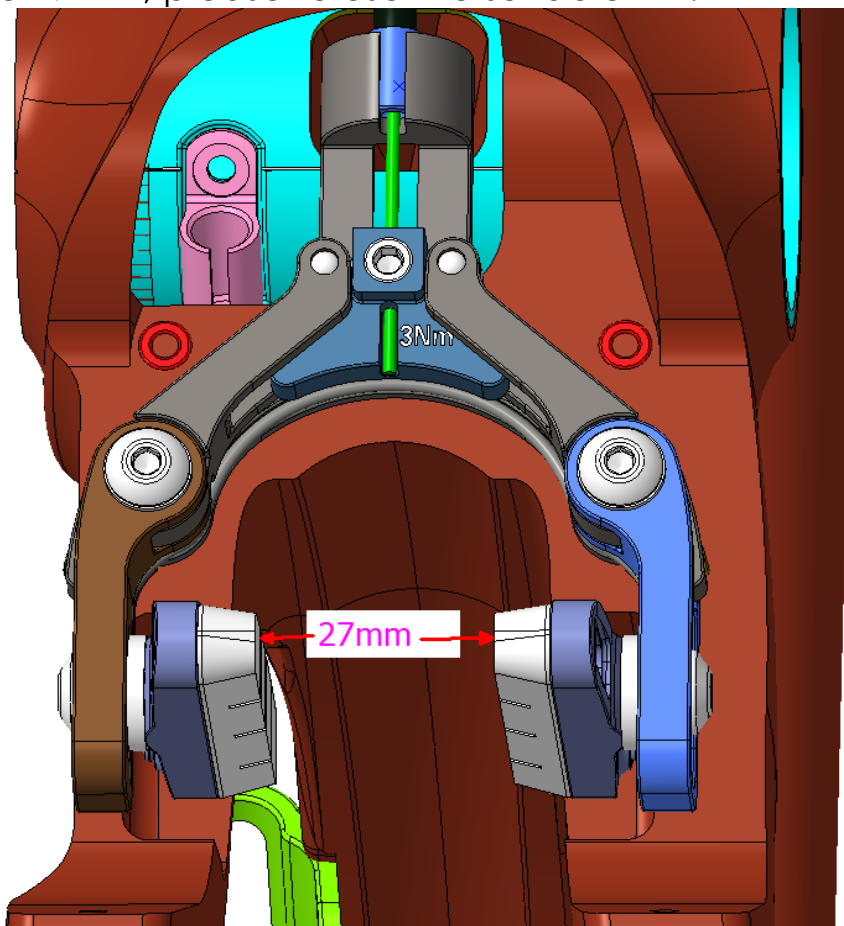

The last step: Assembled the carbon cover on frame or fork.

When mounted the brake shoes in position, please assemble the carbon cover.

So when the brake is assembled well. You are professional, Thanks so much.

